

Cat 6A Shielded Jack

Datasheet: C25 SS1379-EU ENv1

APPLICATION

The Leviton Cat 6A Snap-in jack is part of the Leviton 10GPlus cabling system. This jack uses an innovative housing design to support a fast & reliable cable termination without the need for a IDC punch down tool.

The 10GPlus cabling system is comprised of high-performance cables and connectivity which not only provide a reliable platform for all of today’s network applications, but is also designed to future-proof networks for higher speed protocols such as 10GBASE-T. The 10GPlus system is classified as an Augmented Category 6 and Class E_A product set that is fully backward compatible to Cat6 (Class E) and Cat5e (Class D) products.

FEATURES

- Innovative “Clam Rear” design for fast & superior wire termination
- Easy to install requiring no specialised “punch type” tools
- Dual 568A/B wiring
- Narrow width ideal for panel
- Robust Die cast construction

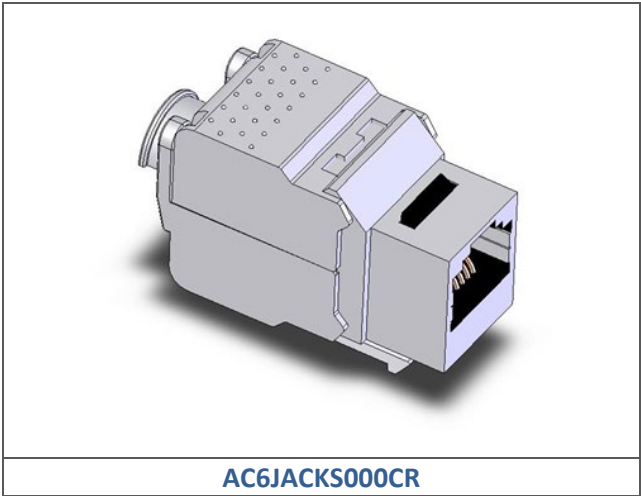

ORDER INFO

Part Number	Item Description	Weight per Item (nom)	Qty per Pack
AC6JACKS000CR	Cat 6A Shielded Jack	25g	12

PHYSICAL CHARACTERISTICS

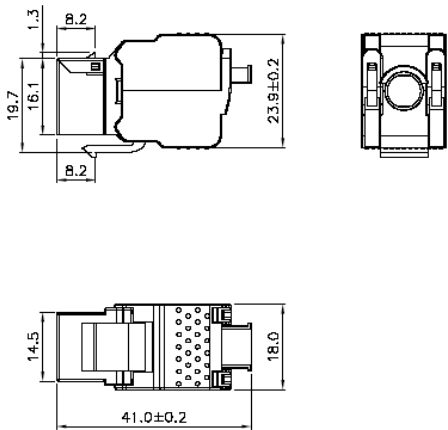

Cat 6A Shielded Jack

Datasheet: C25 SS1379-EU ENv1



ELECTRICAL CHARACTERISTICS

Voltage Proof:	1500V dc / ac peak
Current-temperature derating:	Compliant with IEC 60603-7
Contact Resistance:	<20mΩ
Insulation Resistance:	>500MΩ
Coupling attenuation:	>61dB

MECHANICAL SPECIFICATION

IDC Contacts:	Accept 22-25 AWG wires
Apertures:	The product fits into 14.9mm x 19.8mm (WxH) cut outs with 1.5mm-1.6mm plate thickness
Repeat plug insertions:	>750 mating cycles with an IEC 60603-7 complaint plug Product tested to 2500 insertion cycles
Wiring:	T568 A and B wiring types
Contact Pins:	Phosphor Bronze, Nickel Plated with selective gold plating (50micro-inch min) over contact area

REGULATIONS & COMPLIANCE

RoHS 2011/65/EU Compliant