

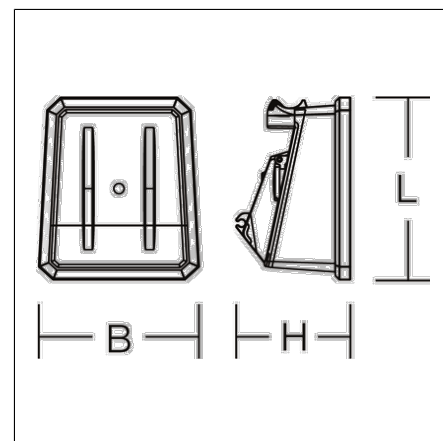

Compact lights
4017506086465
L 250, B 215, H 155

portable
black



Mobile work light. Impact-resistant and break-proof 2-component plastic housing. Edge protection and handle with soft plastic (thermoplastic elastomer - TPE). Cover opal, made of impact- and break-resistant plastic (polycarbonate). Uniform, soft and glare-reduced illumination thanks to multi-LED technology, opal cover and large light emission surface. Two socket outlets on the back side allow the connection of additional luminaires or electrical devices. Ergonomically placed switch. Heavy rubber power supply cable H07RN-F for high mechanical loads with mains plug. Extensive accessories optionally available (tripods, etc.). Luminaire with limited surface temperature in accordance with EN 60598-2-24.

Product specifications

Length L	250 mm
Width B	215 mm
Height H	155 mm
Weight	1.81 kg
Steckdosen	2 x Typ E (CEE 7/5)
Supply cable / plug	2.5 m, H07RN-F, 3 x 1,5 mm ² / Typ E+F (CEE 7/7)
additional functions	with switch
Light source	LED
Colour temperature	5000 K
Rated luminous flux	3400 lm
System power	27 W
System efficiency	126 lm/W
Glare evaluation RUG (4H 8H)	27,2
Beam angle	103°/105°
LED rated life	50000 h (L70/B10)
Colour rendering index (CRI)	80
Colour tolerance (McAdam)	5 SDCM
Photobiological safety according to EN 62471	Risk group 0
Driver	Converter
Control	on/off
Voltage	220 - 240 V / 50 Hz, 60 Hz
Luminaires on B10A fuse	2
Luminaires on B16A fuse	4
Luminaires on C10A fuse	5
Luminaires on C16A fuse	8
Inrush current / Inrush current duration	20 A / 200 µs
CIE Flux Code / CEN Flux Code	50 81 97 100 100
Type of protection	IP 54
Protection class	I
Filament test	650 °C
Impact resistance	IK08
Ambient temperature	-20 °C bis + 40 °C
Safety marks	D-mark
Conformity mark	CE

Accessories



95-0105-0001
Tripod 'Standard', without castors, set incl. tilting holder



95-0106-0001
Tripod 'Standard', with castors, set incl. tilting holder



95-0107-0001
Tripod 'Standard', without castors, set incl. turn/tilt holder



95-0108-0001
Tripod 'Standard', with castors, set incl. turn/tilt holder



95-0003-0001
Tripod 'Standard', without castors



95-0004-0001
Tripod 'Standard', with castors



95-0022-0022
Luminaire bracket, for tripod mounting



95-0023-0022
Female spigots 30 mm



95-0024-0022
U-stand adapter for luminaire bracket, for tripod attachment



95-0017-0022
Spigot 30 mm, conforming to DIN 14640



95-0290-0006
Transport bag for work light

