

# Product End of Life Instructions

## CT Rogowski 900mm coil UL2808 5000A





## Potential disassembly risks

### **⚠ WARNING**

#### **HAZARD OF ELECTRIC SHOCK, EXPLOSION, OR ARC FLASH**

- Do not use this product for life or safety applications
- Mount this product inside a suitable fire and electrical enclosure
- Read, understand and follow the instructions before installing this product.
- Turn off all power-supplying equipment before working on or inside the equipment.
- Use a properly rated voltage sensing device to confirm that power is off. Do not depend on this product for voltage indication.

**Failure to follow these instructions will result in death or serious injury.**



## End of Life Instructions

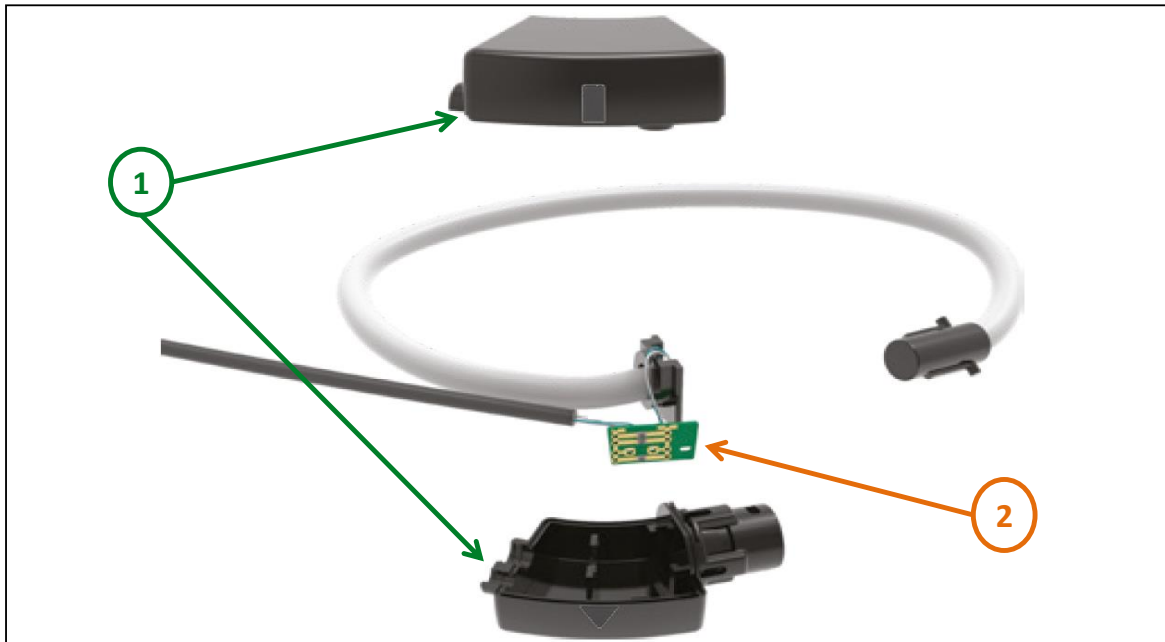

Recommendation	Number on drawing	Component / Material	Weight (in g)	Comment
To be dismantled	1	Plastics	22.7g	Case
To be depolluted	2	PCBA	1.266g	

## Product description

Manufacturer identification	Schneider Electric Industries SAS
Brand name	Schneider Electric
Product function	The CTRx Series of Rogowski flexible rope style Current Transformers (CTs) provide secondary AC voltage proportional to the primary (sensed) current and reinforced insulation between the sensed conductor and the output leads.
Product reference	METSECTR90500U
Additional similar product references	METSECTR30500U, METSECTR46500U, METSECTR60500U
Total representative product mass	175 g
Representative product dimensions	Length 900mm x Thickness 8.3mm
Date of information release	08-2024

## Additional information

Legal information	The product family must be disposed according to the legislation of the country. This document is intended for use by end of life recyclers or treatment facilities. It provides the basic information to assure an appropriate end of life treatment for the components and materials of the product.	
Recyclability potential	30%	Recyclability rate has been calculated based on REEECY'LAB tool developed by Ecosystem, for components/materials not covered by the tool, data from the "ECO'DEEE recyclability and recoverability calculation method" was taken. If no data was found a conservative assumption was used (0% recyclability).

Schneider Electric Industries SAS

Country Customer Care Center

<http://www.se.com/contact>

35, rue Joseph Monier

CS 30323

F- 92500 Rueil Malmaison Cedex

RCS Nanterre 954 503 439

Capital social 928 298 512 €

[www.se.com](http://www.se.com)

ENVEOLI2408025\_V1

Published by Schneider Electric

© 2023 - Schneider Electric – All rights reserved

8/1/2024